

DIN 6325 Dowel Pins															
Diameter	M0.8	M1	M1.5	M2	M2.5	M3	M4	M5	M6	M8	M10	M12	M14	M16	M20
Length															
2	0.008														
3	0.012														
4	0.016	0.025	0.055												
5	0.020	0.032	0.069												
6	0.024	0.038	0.083	0.148	0.230										
8	0.032	0.048	0.111	0.197	0.307	0.443									
10		0.062	0.139	0.246	0.384	0.554	0.985								
12		0.074	0.166	0.296	0.462	0.665	1.18	1.85							
14			0.194	0.345	0.538	0.775	1.38	2.16	3.10						
16			0.222	0.395	0.615	0.886	1.58	2.46	3.55						
18				0.444	0.692	0.996	1.77	2.77	3.99	7.10					
20				0.493	0.769	1.11	1.97	3.08	4.44	7.89					
24					0.924	1.33	2.37	3.7	5.32	9.46	14.8				
28						1.55	2.76	4.32	6.21	11.0	17.2	24.9			
32						1.77	3.15	4.93	7.10	12.6	19.7	28.4			
36							3.55	5.54	7.98	14.2	22.2	31.7	43.5		
40							3.94	6.15	8.86	15.8	24.6	35.5	48.3	63.1	
45								6.93	9.96	17.7	27.7	40.0	54.4	71.0	
50								7.7	11.1	19.7	30.8	44.4	60.4	78.9	123
55									12.2	21.6	33.9	48.8	66.4	86.8	136
60									13.3	23.6	37.0	53.3	72.5	94.6	148
70										27.6	43.2	62.2	84.6	110	173
80										31.5	49.4	71.0	96.6	126	197
90											55.5	79.9	109	142	222
100											61.6	88.8	121	158	246
120												145	189	296	

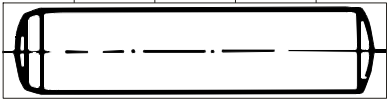

Weight in kgs. per 1,000 pcs. unless otherwise specified. All weights are approximations.
All information is strictly informative